

START HERE!

READ ME FIRST

Don't be a hero and muscle through this installation without reading these fitting instructions first! Improper installation of this gear may void certain aspects of your warranty.

Before you begin, take a moment and open all your Front Runner rack kit boxes and gather the assembly instructions for the various components.

A complete kit will contain:

1. A Front Runner Mounting System specific to your vehicle
2. A Front Runner Rack Tray or Load Bar Slats

This document will guide you through the assembly of the mounting system and assist you in fitting the roof rack tray or load bars to your specific vehicle.

Please refer to the next page for a list of all the components, quantities and tools required.

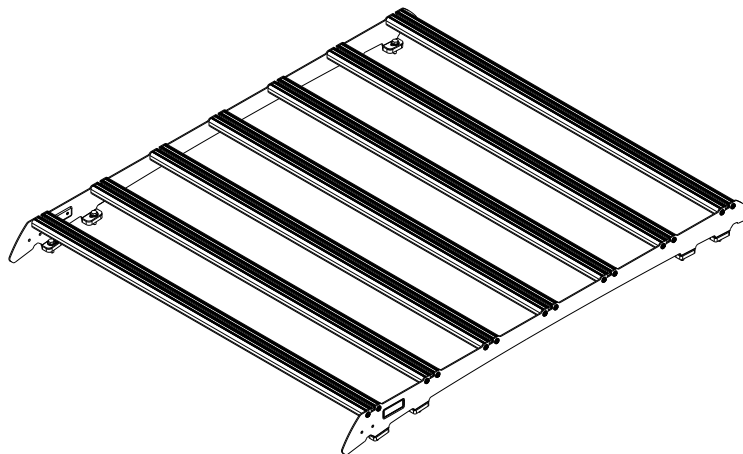

IMPORTANT WARNING!

IT IS CRITICAL THAT ALL FRONT RUNNER PRODUCTS BE PROPERLY AND SECURELY ASSEMBLED AND ATTACHED TO YOUR VEHICLE. IMPROPER ATTACHMENT COULD RESULT IN AN AUTOMOBILE ACCIDENT, AND COULD CAUSE SERIOUS BODILY INJURY OR DEATH. YOU ARE RESPONSIBLE FOR ASSEMBLING AND SECURING ALL FRONT RUNNER PRODUCTS TO YOUR VEHICLE, CHECKING THE ATTACHMENTS PRIOR TO USE, AND PERIODICALLY INSPECTING THE PRODUCTS FOR ADJUSTMENT, WEAR AND DAMAGE. THEREFORE, YOU MUST READ AND UNDERSTAND ALL OF THE INSTRUCTIONS AND PRECAUTIONS SUPPLIED WITH YOUR FRONT RUNNER PRODUCT PRIOR TO INSTALLATION OR USE. IF YOU DO NOT UNDERSTAND ALL OF THE INSTRUCTIONS AND CAUTIONS, OR IF YOU HAVE NO MECHANICAL EXPERIENCE AND ARE NOT THOROUGHLY FAMILIAR WITH THE INSTALLATION PROCEDURES, YOU SHOULD HAVE THE PRODUCT INSTALLED BY A PROFESSIONAL INSTALLER OR OTHER QUALIFIED PERSONNEL.

NOTE: Front Runner will not be responsible for any damage caused by the failure to install the product according to these instructions.

Please call us if you have any questions about the installation of this product.



1 GET ORGANIZED

IN THE BOX

1	1 X	Foot Rail LH
2	1 X	Foot Rail RH
3	7 X	Standard Slat
4	8 X	Spacer 10mm
5	28 X	M6 x 20 Button Head Screw
6	8 X	M8 x 19 x 2 SS Flat Washer
7	8 X	M8 x 30 Hex Bolt
8	8 X	M8 Nut Cap

TOOLS NEEDED

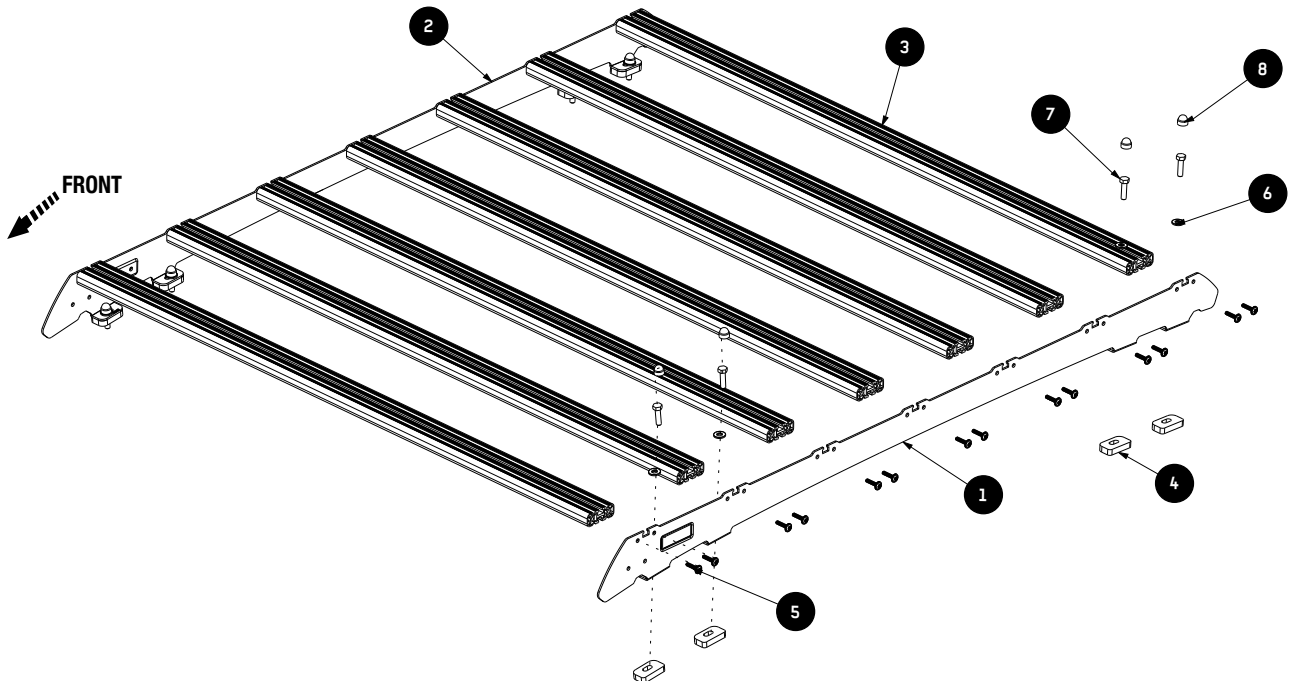
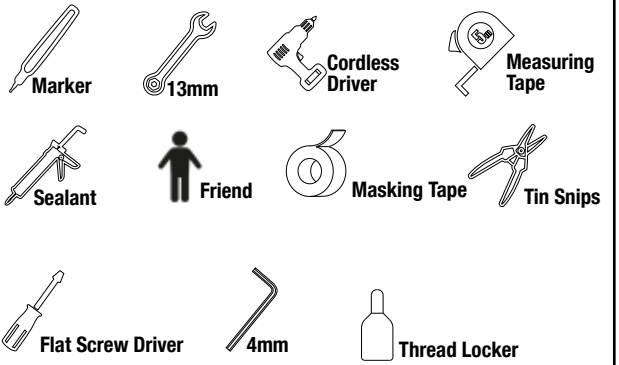

2

FIT AND SECURE

2.1

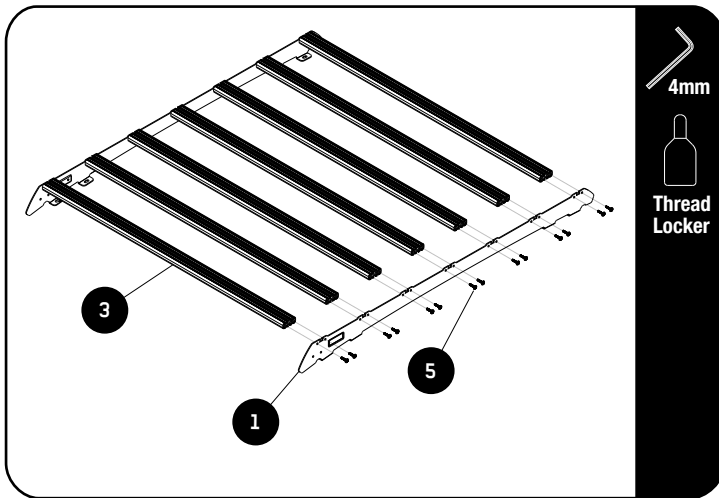

Fit 7 Slimsport Slats (Item 3) to the Foot Rails (Item 1) using 28 x M6 x 20 Button Head Screws (Item 5) as shown.



Apply a little Thread Locker on screw threads before inserting.



Tightening Torque 8-10Nm / 5.9 ft lb - 7.38 ft lb. Take care when using a cordless driver.

3

FIT AND SECURE - MODELS WITH DITCH MOLDING

3.1

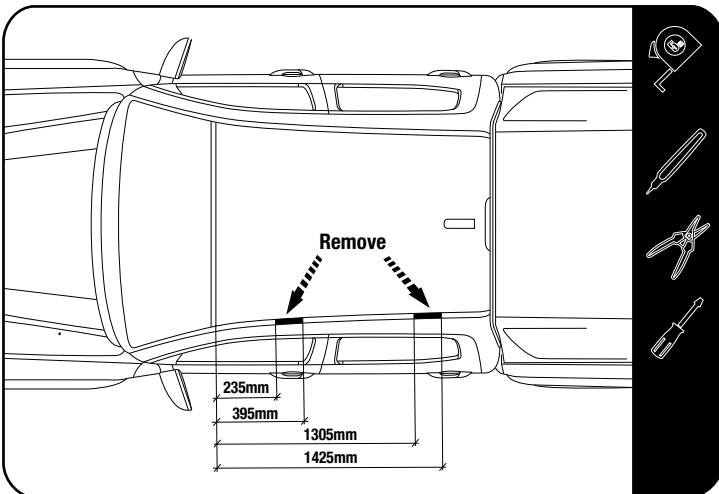

Starting at the front of the windscreen as shown, measure along the Ditch Moulding towards the rear of the vehicle. Mark the ditch moulding at the following distances.

- 235mm
- 395mm
- 1305mm
- 1425mm

Using a suitable panel tool, or screw driver wrapped in tape, lift the Ditch Moulding between the marks you made. Using tin snips and cut the Ditch Moulding on the marks made.



Be careful when lifting the Ditch Moulding not to lift it too high as this might damage the Moulding.

3.2

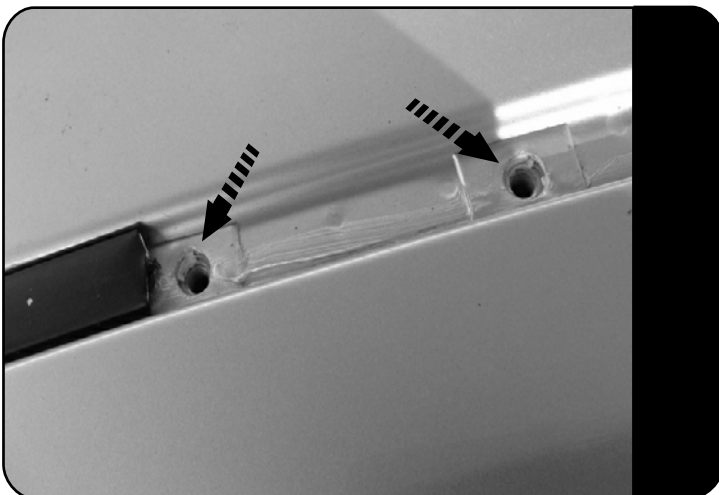

Looking at the ditch where you have just removed the ditch moulding, locate the four Threaded Mounting points in the vehicle's roof and remove the protective tape covering them.

3.3

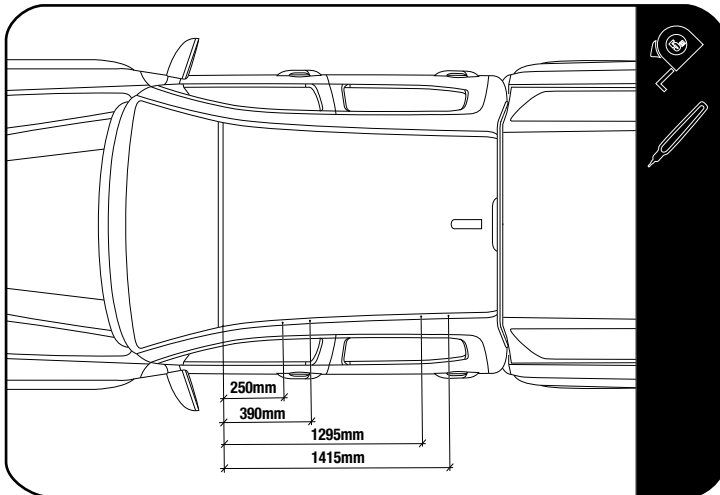

Note: Depending on the region of manufacture, the vehicle may have a thin metal skin covering the threaded mounting holes, in this case refer to step 3.4 to drill them open.

If the threaded mounting holes are visible move forward to step 3.5.

3.4

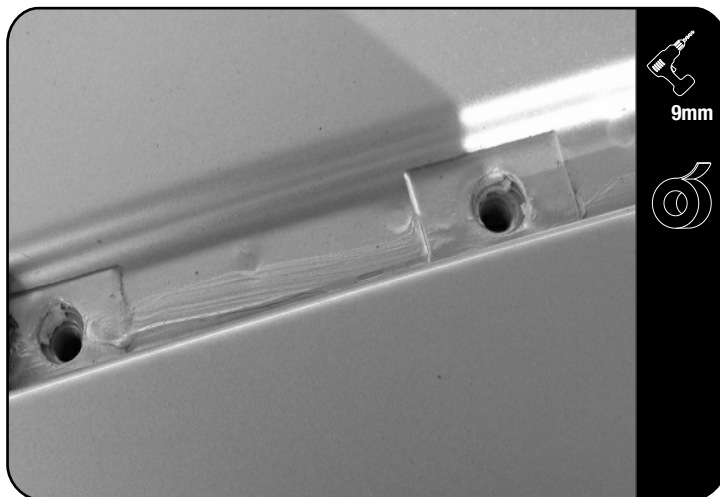

Use a center punch to prevent the drill bit from slipping when drilling, punch the marked locations.

Use a 9mm drill bit and tape the drill bit 4mm from the tip of the drill bit. The thin metal skin is soft you will only need to apply a small amount of pressure to drill open the thin metal skin covering the threaded mounting holes.

Note: Do not drill too deep as this will damage the threads within the drilled pocket.

Once drilled the threads will be visible through the drilled holes, as shown.

3.5

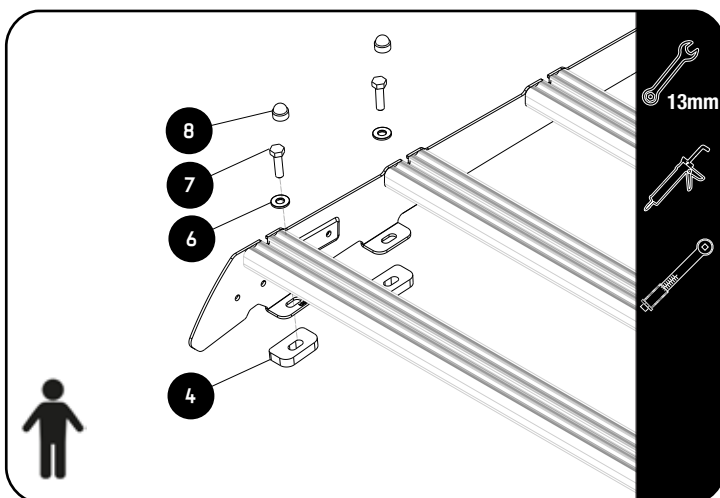

Apply a bead of sealant on the threads of the M8 x 30 Hex Bolts (Item 7) and in the cut outs for the Front and Rear Spacers (Items 4).

Secure the Tray together with Front and Rear Spacers to the Roof using M8 x 30 Hex Bolts, M8 x 19 x 2 Flat Washers and (Items 6, 7).

Do this for LH and RH side and fully tighten the M8 x 30 Hex Bolts.

Place M8 Nut Caps (Item 8) over all M8 x 30 Hex Bolts.



Tightening Torque:

M8 : 15-20Nm / 11.06 ft lb - 14.75 ft lb

3

FIT AND SECURE - MODELS WITH DITCH MOLDING

3.6

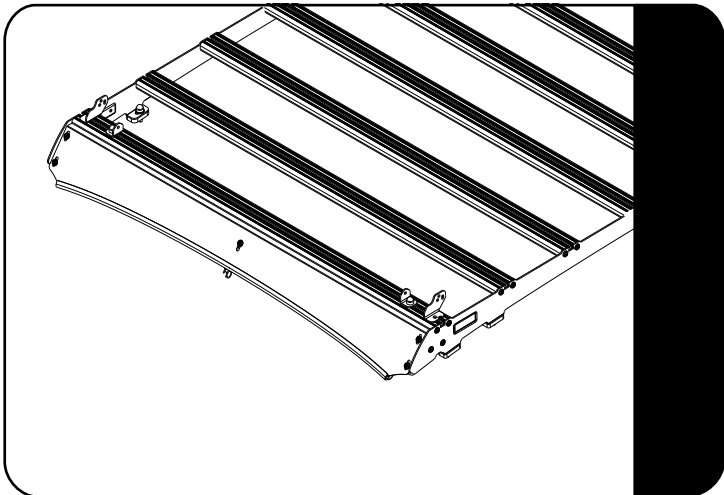

STANDARD WIND FAIRING ASSEMBLY



Refer to fitment guide RRAC310.

3.7

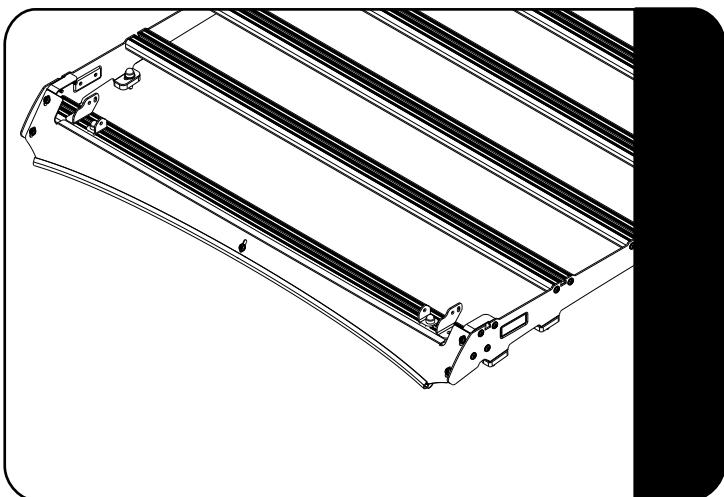

LIGHT BAR WIND FAIRING ASSEMBLY



Refer to fitment guide RRAC309.

4

FIT AND SECURE - MODELS WITH OEM RAILS

4.1



Fit 7 Slimsport Slats (Item 3) to the Foot Rails (Item 1) using 28 x M6 x 25 Thread Forming Screws (Item 5) as shown.



Look on Youtube for assistance on how to remove the OEM roof rails.

4.2

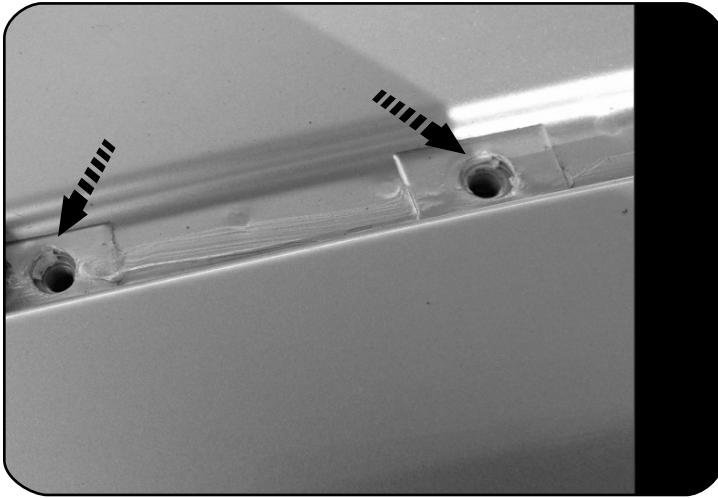

Looking at the Ditch, where you have just removed the OEM Roof Rails, locate the four threaded mounting points in the vehicle's roof.

4.3

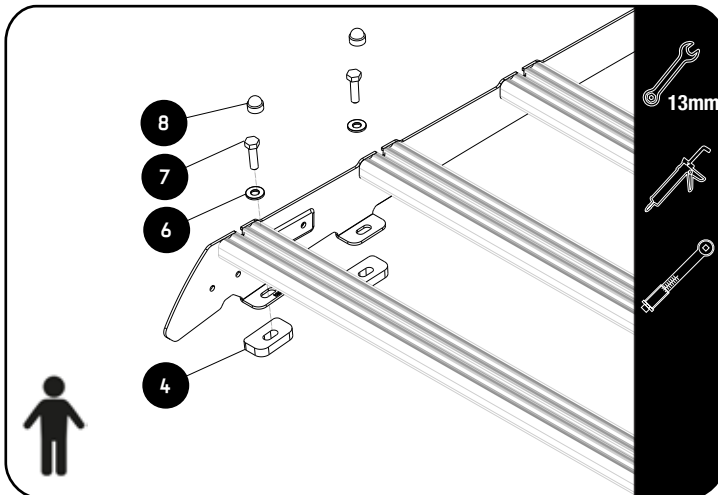

Apply a bead of sealant on the threads of the M8 x 30 Hex Bolts (Item 7) and in the Mounting holes for the Front and Rear Spacers (Items 4).

Secure the Tray together with Front and Rear Spacers to the Roof using M8 x 30 Hex Bolts, M8 x 19 x 2 Flat Washers and (Items 6, 7).

Do this for LH and RH side and fully tighten the M8 x 30 Hex Bolts.

Place M8 Nut Caps (Item 8) over all M8 x 30 Hex Bolts.



Tightening Torque:

M8 : 15-20Nm / 11.06 ft lb - 14.75 ft lb

4.4

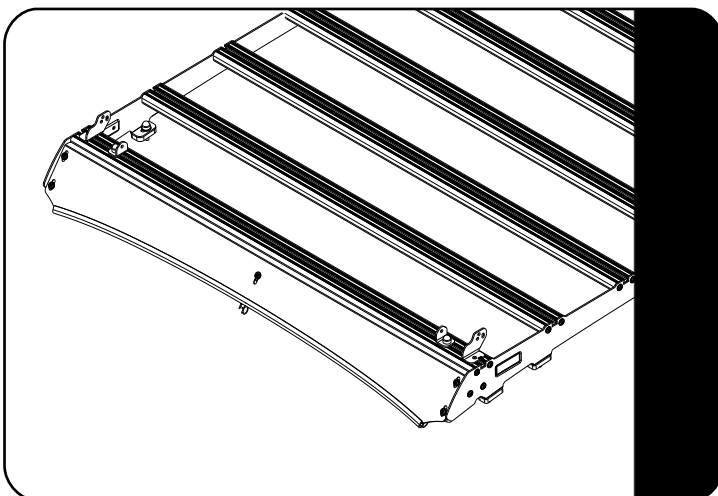

STANDARD WIND FAIRING ASSEMBLY



Refer to fitment guide RRAC310.

4 FIT AND SECURE - MODELS WITH OEM RAILS

4.5

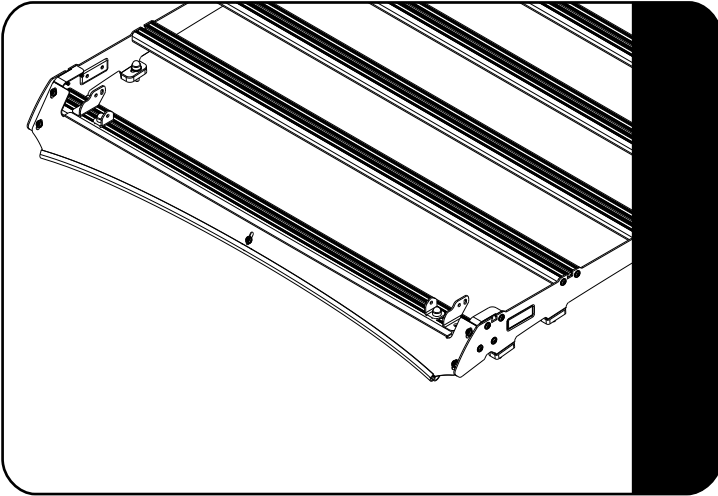

LIGHT BAR WIND FAIRING ASSEMBLY

Refer to fitment guide RRAC309.

5 COMPLETION

5.1

Congratulations! You did it. Take a step back and admire your work!



6 INSTALL OTHER VEHICLE AND RACK ACCESSORIES

Now's the time to visit your favorite Front Runner dealer in person or online.

IMPORTANT! ⚠️

FRONT RUNNER RACK KITS OFTEN HAVE A HIGHER LOAD RATING THAN THE VEHICLES THEY ARE MOUNTED TO. PLEASE REFER TO YOUR SPECIFIC VEHICLE MANUFACTURER FOR A RECOMMENDED ROOF RATING. FRONT RUNNER CANNOT BE RESPONSIBLE FOR IMPROPER LOADING BEYOND THE VEHICLE MANUFACTURER'S STATED LOAD CAPACITY.

Be sure to tag us. We love to see our gear in action! #FrontRunnerOutfitters

Share your adventures on: 