

READ ME ! ⚠

Thank you for purchasing a Ineos Grenadier Interior Shelf.

Before you start, take a moment to familiarize yourself with the Fitting Instructions and the included components.

Refer to Page 2 for a list of all the components, quantities and tools required.

IMPORTANT WARNING! ⚠

IT IS CRITICAL THAT ALL FRONT RUNNER PRODUCTS BE PROPERLY AND SECURELY ASSEMBLED AND ATTACHED TO YOUR VEHICLE. IMPROPER ATTACHMENT COULD RESULT IN AN AUTOMOBILE ACCIDENT, AND COULD CAUSE SERIOUS BODILY INJURY OR DEATH. YOU ARE RESPONSIBLE FOR ASSEMBLING AND SECURING ALL FRONT RUNNER PRODUCTS TO YOUR VEHICLE, CHECKING THE ATTACHMENTS PRIOR TO USE, AND PERIODICALLY INSPECTING THE PRODUCTS FOR ADJUSTMENT, WEAR AND DAMAGE. THEREFORE, YOU MUST READ AND UNDERSTAND ALL OF THE INSTRUCTIONS AND PRECAUTIONS SUPPLIED WITH YOUR FRONT RUNNER PRODUCT PRIOR TO INSTALLATION OR USE. IF YOU DO NOT UNDERSTAND ALL OF THE INSTRUCTIONS AND CAUTIONS, OR IF YOU HAVE NO MECHANICAL EXPERIENCE AND ARE NOT THOROUGHLY FAMILIAR WITH THE INSTALLATION PROCEDURES, YOU SHOULD HAVE THE PRODUCT INSTALLED BY A PROFESSIONAL INSTALLER OR OTHER QUALIFIED PERSONNEL.

NOTE: Front Runner will not be responsible for any damage caused by the failure to install the product according to these instructions.

Please call us if you have any questions about the installation of this product.

1

GET ORGANIZED

IN THE BOX

1	1 X	Shelf Tray RH
2	1 X	Shelf Tray LH
3	1 X	Shelf Tray Center
4	2 X	Mounting Brackets
5	16 X	Spacer
6	8 X	M6 x 16 Button Head Bolt
7	10 X	M6 x 12 Button Head Bolt
8	18 X	M6 Nut Caps
9	18 X	M6 Nyloc Nut
10	4 X	Flat Washer M8 x 19 x 2
11	4 X	Cap Screw M8 x 65

TOOLS NEEDED



4mm



10mm



Torx
T40



FIGURE 1.1

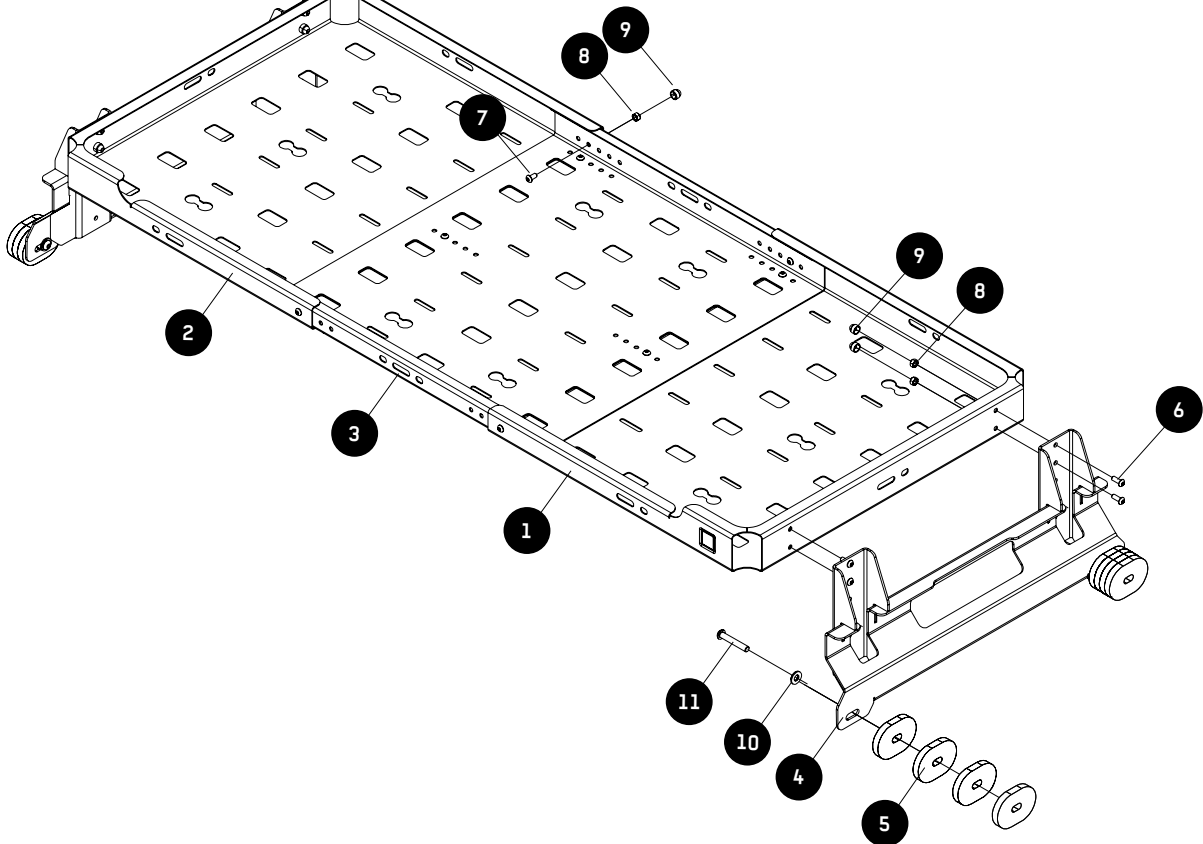

2

FIT AND SECURE

2.1



Remove all four tie downs points indicated, two each side inside the vehicle.

2.2

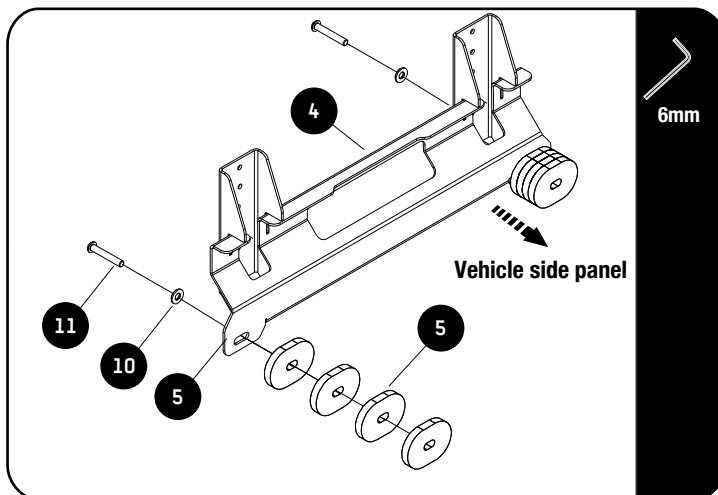

Assemble the Mounting Bracket (Item 4) to where the tie down points was removed earlier using four Spacers (Item 5) per mounting point, M8 x 65 Cap Screws and M8 Flat Washers (Items 10 & 11) as shown.



Tightening Torque:

M8 : 15-20Nm / 11.06 ft lb - 14.75 ft lb

2.3

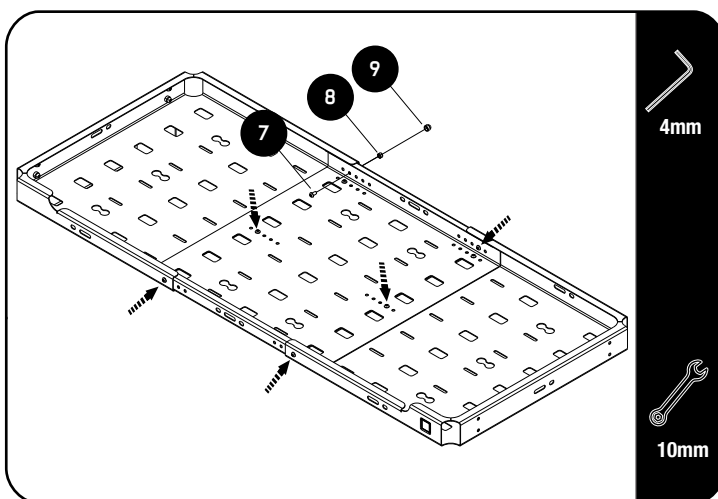

Loosely assemble both Side Trays (Items 1 & 2) to the Center Tray (Item 3) using M6 x 12 Button Head Bolts and M6 Nyloc Nuts Items 7 & 8).

Note the hole position to be used.

The fasteners will be fully tightened after the tray is fitted in the vehicle.

2

FIT AND SECURE

2.4

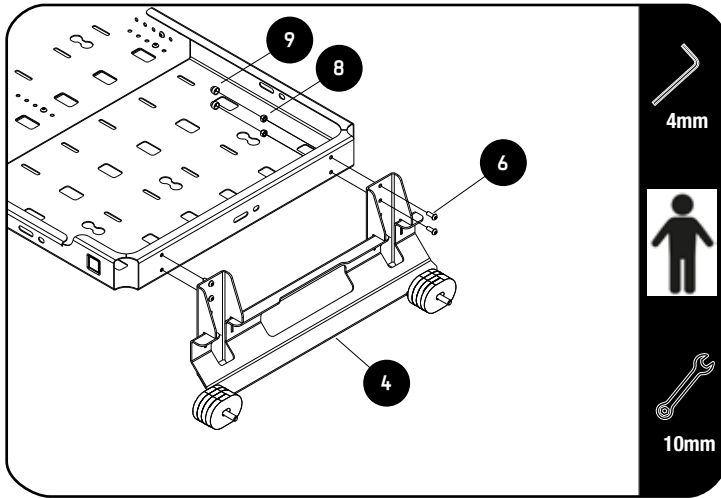

Depending on the space needed, you can install the tray in a Low or High position.



With the help of a friend secure the Tray assembly from 2.3 to the Mounting Brackets using M6 x 16 Button Head Bolts and M6 Nyloc Nuts (Items 6 & 8) as shown.

Place M6 Nut Caps (Item 9) on the nyloc nuts.

Fully tighten all fasteners.



Tightening Torque:

M6 : 8-10Nm / 5.9 ft lb - 7.38 ft lb

M8 : 15-20Nm / 11.06 ft lb - 14.75 ft lb

3

FINISH

Congratulations! You did it. Take a step back and admire your work!

4

INSTALL OTHER VEHICLE AND RACK ACCESSORIES

Now's the time to visit your favorite Front Runner Dealer in person or online.

Be sure to tag us. We love to see our gear in action! #FrontRunnerOutfitters

Share your adventures on:    